

Sanitary/Sanitary Step-Up Tri-Clamp®

Hose Fitting Specifications



Style 10/10U

Description

Step-up styles are designed with "blended" internal surfaces to prevent material build-up or entrapment. Gasket face dimensions are standard to industry specifications.

Materials

- Type 316L Stainless Steel standard.
- Polypropylene, PVDF & other materials available by special order.

Temperature/Pressure rating

Pressure and temperature ratings of sanitary assemblies are dependent upon clamp pressure ratings and gasket material temperature ratings. Generally clamps are pressure rated as follows:

Standard Weight Style

150 PSIG @ 70°F
125 PSIG @ 250°F

Heavy Weight Style

500 PSIG @ 70°F
250 PSIG @ 250°F

High Pressure Bolt Style

1500 PSIG @ 70°F
1200 PSIG @ 250°F

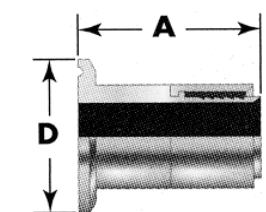

SANITARY
STYLE 10

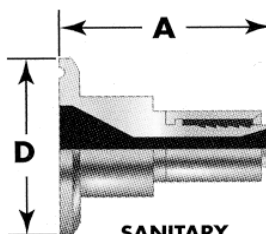

SANITARY
JUMP SIZE
STYLE 10U

Sanitary Specifications Style 10 and 10U

Hose Size ID (in.)	Part Number	Description	ID (in.)	Flange Diameter 'D' (in.)	Overall Length 'A' (in.)
1/4	160410SKO	1/4" x 1"	0.19	1.98	1.46
3/8	160610SKO	3/8" x 1"	0.30	1.98	1.85
1/2	160810SKO	1/2" x 1"	0.40	1.98	2.19
1/2	160810USK	1/2" x 1 1/2"	0.40	1.98	2.22
3/4	381210SKO	3/4" x 1"	0.65	1.98	2.39
3/4	381210USK	3/4" x 1 1/2"	0.65	1.98	2.39
1	381610SKO	1" x 1"	0.87	1.98	2.39
1	381610USK	1" x 1 1/2"	0.87	1.98	2.45
1 1/2	382410SKO	1 1/2" x 1 1/2"	1.37	1.98	3.125
1 1/2	382410USK	1 1/2" x 2"	1.37	2.490	2.40
2	383210SKO	2" x 2"	1.75	2.490	3.980
2 1/2	384010SKO	2 1/2" x 2 1/2"	2.20	3.050	4.200
3	384810SKO	3" x 3"	2.76	3.580	4.400
4	386410SKO	4" x 4"	3.75	4.675	5.000

Sanitary/Sanitary Step-Up Tri-Clamp®

Tri-Clamp® Fitting Size Guide

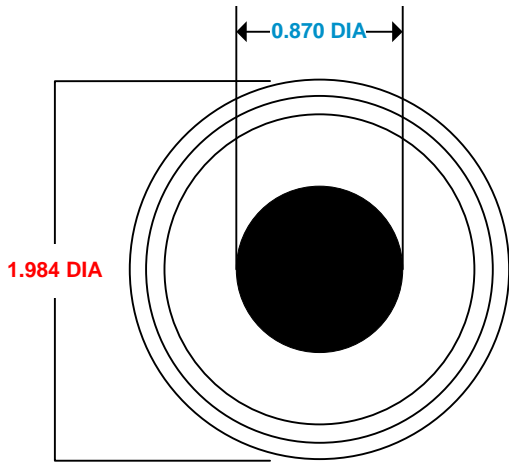

1" LADDISH Tri-Clamp

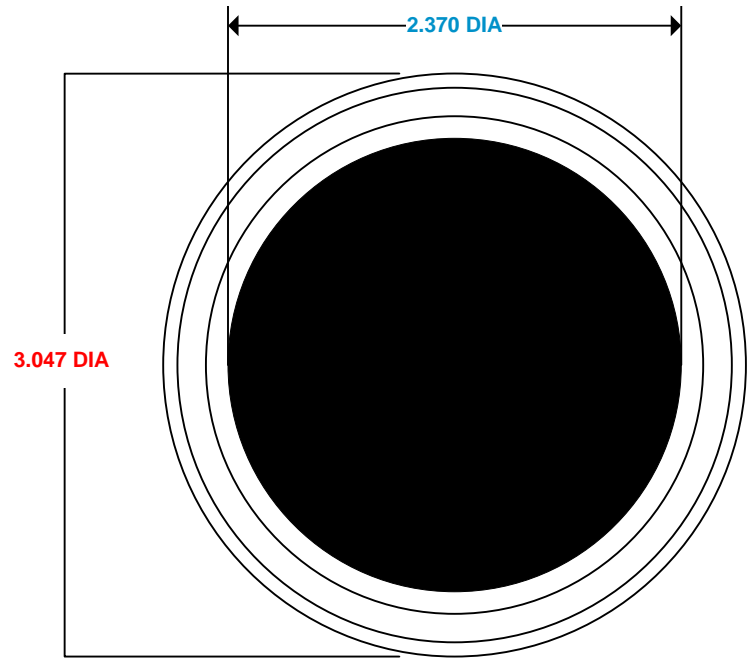

2 1/2" Tri-Clamp

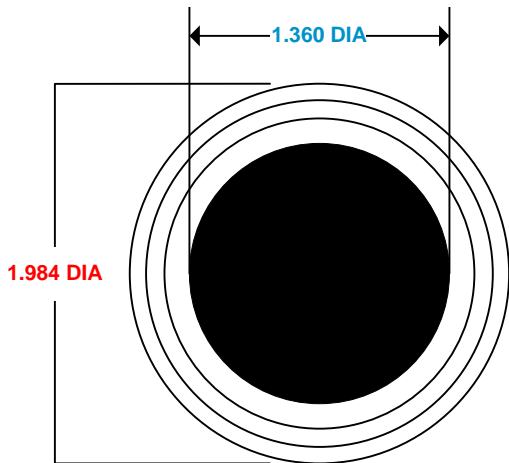

1 1/2" Tri-Clamp

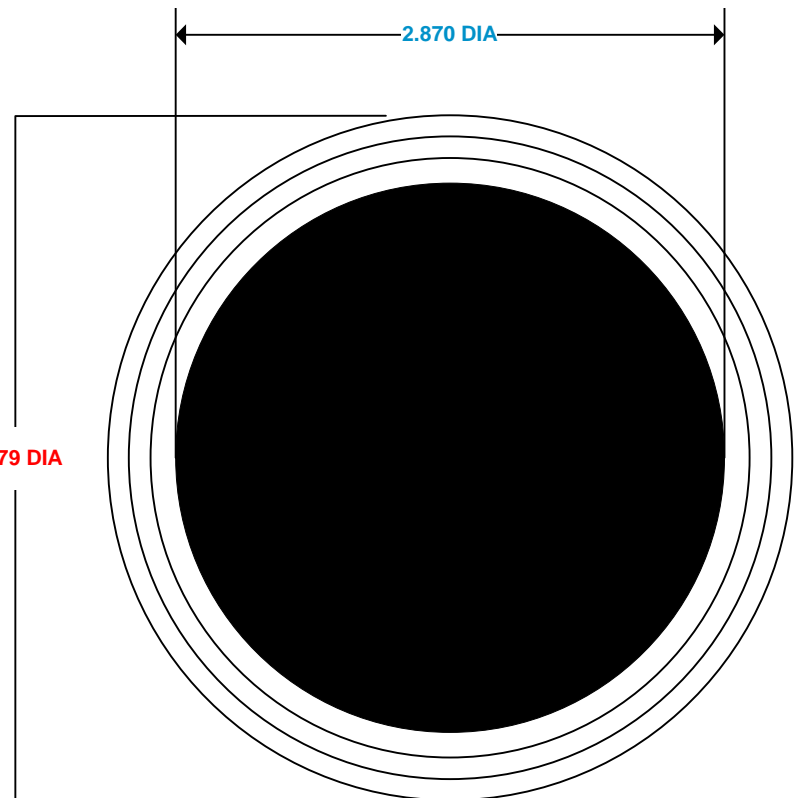

3" Tri-Clamp

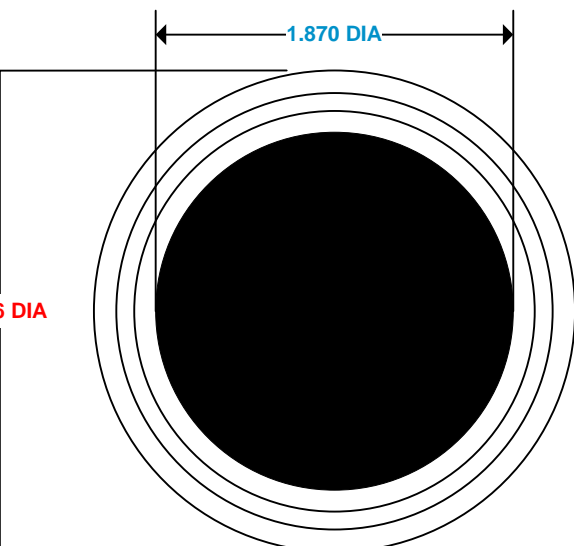

2" Tri-Clamp